



CONVENIENT ALL-IN-ONE UV/FILTER SYSTEMS

Models: AAW4/5-Z1, AAW4/5-Z2, AAW4/5-Z12, AAW4/5-Z2C, AAW4/5-Z12C, AAW4/5-Z22C

This new line of rack-mounted UV/filtration systems offer the convenience of an all-in-one package making installation a simple “in & out” connection.

Designed to effectively treat flow rates of 8 & 15 gpm, rack-mounted UV’s provide the required 5 micron pretreatment with the option of a full-flow, carbon filter to treat taste and odour. Installation of a UV system has never been easier with an innovative design that allows for feedwater to enter the filters from either the right or left side of the unit.

Based on our groundbreaking modular UV systems, the rack-mount UV’s offer the flexibility of being “factory ready” to accept a UV Intensity Module in the future if so desired. The plug and play platform has the most advanced residential controller on the market with a colour screen user interface giving a multitude of screens displaying diagnostics, status, warnings and even QR codes for a link back to American Air & Water’s website.*

Combine this with the capability to fully customize the colour screens with your own dealer information, or different language, and you can easily see how this integrated UV/filter system shines above all others (an optional Custom Dealer Programmer is required, contact factory for further information).*

Systems feature one-piece, 2-sump filter heads for a leak-free design
(On 2-sump units only)

120 psi operating pressure, o-ring groove for fail-safe installation, silicon lubricant, pressure relief valve

Sample Screens



Product Features

- One-piece, 2-sump design for leak free operation, (pressure relief, wrench, and new integral hanging clip included with all systems)
- LED lamp countdown (AAW4 variants)
- Controller with lamp key technology for protected lamp sales (AAW5 variants)
- Universal mounting configuration (left or right access)
- NSF component listed filtration cartridges (included with systems)
- “Future-proof” expandability port for future upgrades and options
- Axial flow, 316L stainless steel polished reactors, fully polished, designed & manufactured to ASME pressure vessel standards
- Reliable, industry proven, coated UV lamps, (9,000 hour life on AAW4/5 series and 10,000 hour life on AAW4/5-C series)
- Full customization available as an option (language, home screen, phone, QR codes, etc.)*

Manufacturer’s Warranty

REACTORS - Ten (10) year Limited Warranty
ELECTRONICS - Three (3) year Limited Warranty
UV LAMPS - One (1) year Limited Warranty
QUARTZ SLEEVES - One (1) year Limited Warranty



Guaranteed OEM Lamp Replacement with Lamp Key Technology

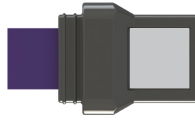

Tired of losing that lucrative replacement lamp sale to a cut-rate online marketer or to an inferior offshore manufacturer? Protect your replacement lamp revenue stream with American Air & Water's proprietary UV lamps with lamp key technology. Maintain your lamp sales and more importantly your lamp margin all while protecting the integrity of the product and its performance.

Equipment Specifications

MODEL	AAW4-Z1 AAW5-Z1	AAW4-Z2 AAW5-Z2	AAW4-Z12 AAW5-Z12	AAW4-Z2C AAW5-Z2C	AAW4-Z12C AAW5-Z12C	AAW4-Z22C AAW5-Z22C
Flow Rate (30mJ/cm ² @ 95% UVT)	8.0 GPM			15.0 GPM		
	30.3 lpm			56.8 lpm		
	1.82 m ³ /hr			3.4 m ³ /hr		
1st Filter Housing	5 micron sediment LC-105-AAW	5 micron sediment LC-205-AAW	5 micron sediment LC-105-AAW	5 micron sediment LC-205-AAW	5 micron sediment LC-105-AAW	5 micron sediment LC-205-AAW
2nd Filter Housing	N/A	N/A	High-capacity carbon LC-20C-AAW	N/A	High-capacity carbon LC-20C-AAW	
Port Size	1" MNPT					
Electrical	90-265V/50-60Hz.					
Plug Type	American: NEMA 5-15P					
Lamp Watts	20 (standard-output lamp)			45 (high-output lamp)		
Power (Watts)	23 (21 @ 230V.)			57 (48 @ 230V.)		
Max Current (amps)	1					
Chamber Material	Polished 316L stainless steel, A249 pressure rated tubing					
Reactor Dimensions	3.5 x 20.0" (8.9 x 50.8 cm)					
Controller Dimensions	17.2 x 9.2 x 10.2 cm (6.8 x 3.6 x 4")			21.7 x 10.8 x 10.2 cm (8.6 x 4.2 x 4")		
Operating Pressure	0.7-8.3 bar (10-120 psi)					
Operating Water Temperature	2-40° C (36-104° F)					
Replacement Lamp	AAW-L420			AAW-L420C		
Replacement Sleeve	AAW-Q420					
UV Monitor	Optional (requires additional UV sensor module) (AAW-S2 on AAW5 units & AAW-S3 on AAW5-C units)					
Solenoid Output	YES (optional solenoid module (MOD-SOL1-AAW) sold separately)					
Dry Contacts	YES (remote alarm module (MOD-RAM-AAW) sold separately)					
4-20mA Output	YES (4-20mA module (MOD-420-AAW) sold separately)					
Lamp Change Remind-er (audible & visual)	YES					
Lamp Out Indicator (audible & visual)	YES					
Shipping Weight	25 lbs	27.4 lbs	40.6 lbs	28.2 lbs	41.4 lbs	44.4 lbs

Optional Equipment Modules

UV Concierge

Available for WEB, iOS, and Android platforms providing live, dynamic feedback on all features and functions of your UV system.



Water Quality Monitor

Installs on AAW5/5-C systems and allows for remote monitoring of all major and minor alarms that take place on the main UV system. Three LED's visually display system functionality from up to 150' (46m) away.



Custom Dealer Programmer

Customize your UV controller with your own company name, logo, website, QR code and contact information. Capture the lucrative replacement lamp market by creating a direct link back to your own website!



UV Sensor Module

Allows the 254nm UV wavelength to be measured and displayed via the controller. The sensor plugs directly into the controller and is mounted in the sensor port located on all reactors.



Solenoid Module

Used to power a remote normally closed solenoid valve (not included). Solenoid will close on lamp failure or when low UV conditions are detected by the sensor.



TRV (temperature management relief valve)

TRV allows for a small amount of water to be physically released (dumped) from the UV unit to allow for cooling of the water. Used in applications of extended "no flow" conditions, or when the temperature of the treated water is of a critical nature.



Cooling Fan

To reduce water temperature inside the reactor through mechanics and convection without wasting any water. Runs independently and continuously. Comes with a compact modular power adapter with interchangeable AC clips that operates from 90-264V (47-63Hz.)



4-20mA Module

Used for signal transfer to a remote device such as a data logger or computer.



Remote Alarm (Dry Contact) Module

Used for signal transfer to a remote alarm or dry contacts.



* Available on AAW5/5-C systems only.

Distributed by: Eco-Smart, Inc. (941)376-8484 ph / info@eco-smart.com