

RIDGEMOOR

ENERGY WISE HOME

OVERALL DIMENSIONS

52'-0" x 52'-0"

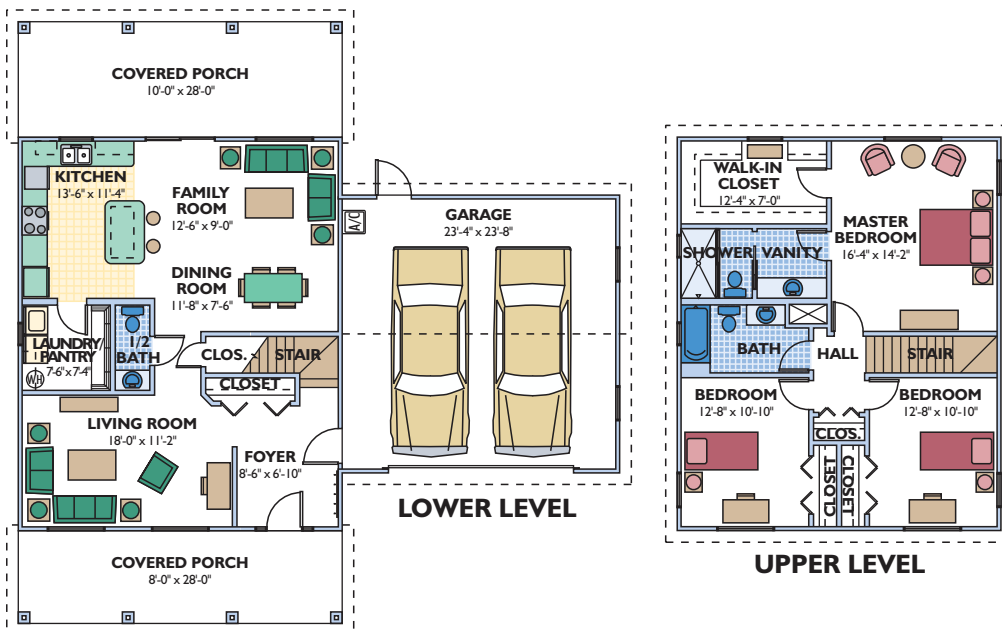
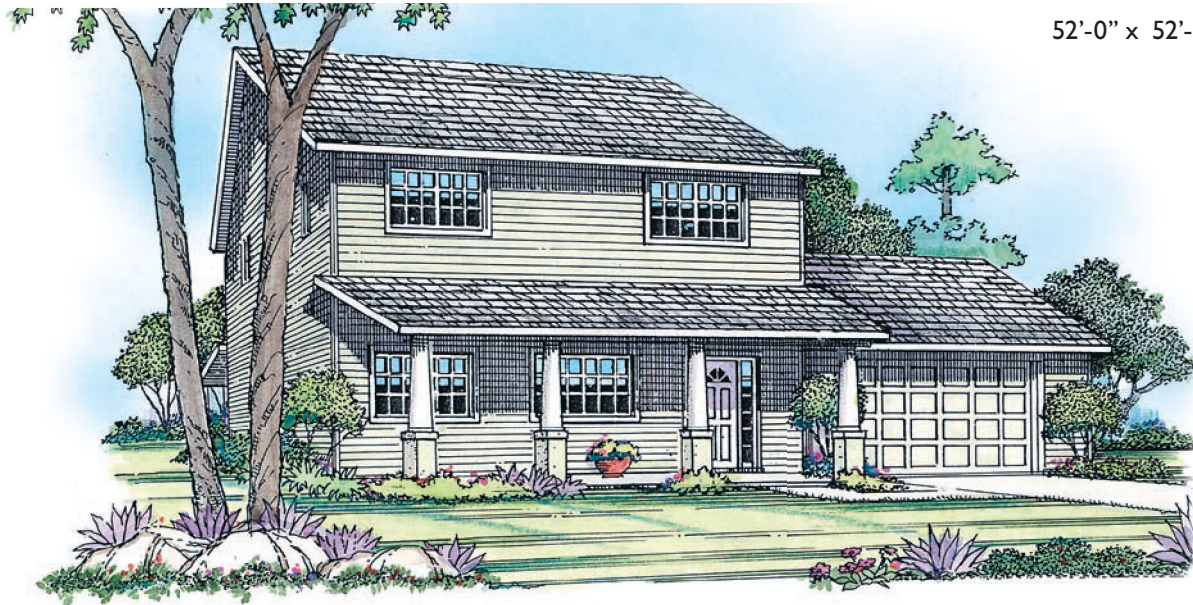

Two covered porches provide a great deal of space for relaxation with friends and family. The columns add character and make the entryway inviting. Inside the living and family rooms also offer plenty of room for entertaining, and the kitchen is large enough to make the cook's job enjoyable.

TOTAL LIVING AREA - 1,904 SQ. FT.

3 bedroom, 2-1/2 bath, 2 car garage

Eco-\$mart offers a complete line of pre-cut and pre-engineered home and building packages utilizing structural insulated panel technology (SIPs). All packages erect quickly, are stronger than conventional framing and extremely energy efficient. SIPs can be clad in conventional OSB or in steel incorporating the patented Secure-Lock panel connection.

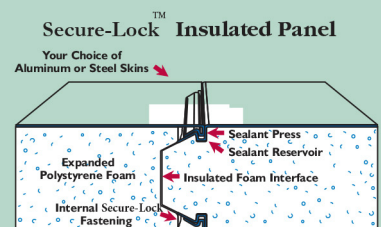

Patent No.'s 4,769,963 and 5,086,599

Dual Plywood Spline Joint

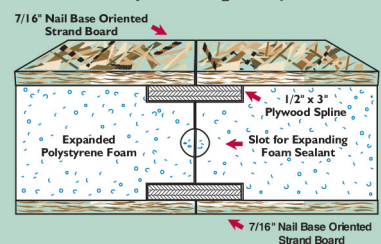

ECO-\$MART, INC

TOLL FREE:(888)329-2705 info@eco-smart.com www.eco-smart.com

Plans and specifications are subject to change without notice. All dimensions are approximate.