

GULFPORT

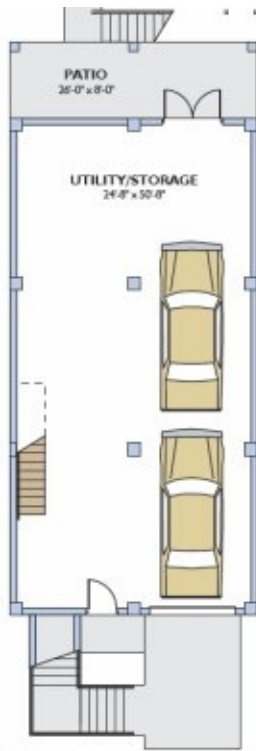

▲ GROUND FLOOR PLAN



**◀ FIRST FLOOR PLAN
SECOND FLOOR PLAN ▼**

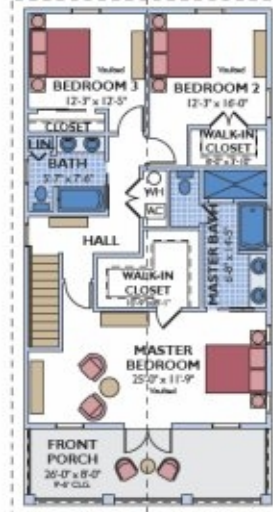

OVERALL DIMENSIONS

26'-0" x 76'-0"

1st Flr. Living	1,037 sq. ft.	Covered Porch	
2nd Flr. Living	1,144 sq. ft.	& Lanai	524 sq. ft.
Utility	1,352 sq. ft.	Deck & Patio	416 sq. ft.
TOTAL - 4,473 sq. ft.		3 story, 3 bedroom, 2-1/2 bath	

Plans and specifications are subject to change without notice. All dimensions are approximate.

Eco-Smart offers a complete line of pre-cut and pre-engineered home and building packages utilizing structural insulated panel technology (SIPs). All packages erect quickly, are stronger than conventional framing and extremely energy efficient. SIPs can be clad in conventional OSB or in steel incorporating the patented Secure-Lock panel connection.

Secure-Lock™ Insulated Panel

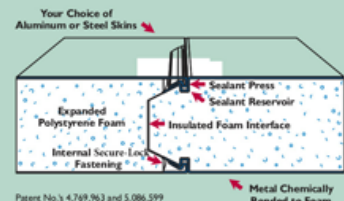

Patent No.'s 4,769,963 and 5,086,599

Dual Plywood Spline Joint

