

CELEBRATION

ENERGY WISE HOME

OVERALL DIMENSIONS

38'-0" x 60'-0"

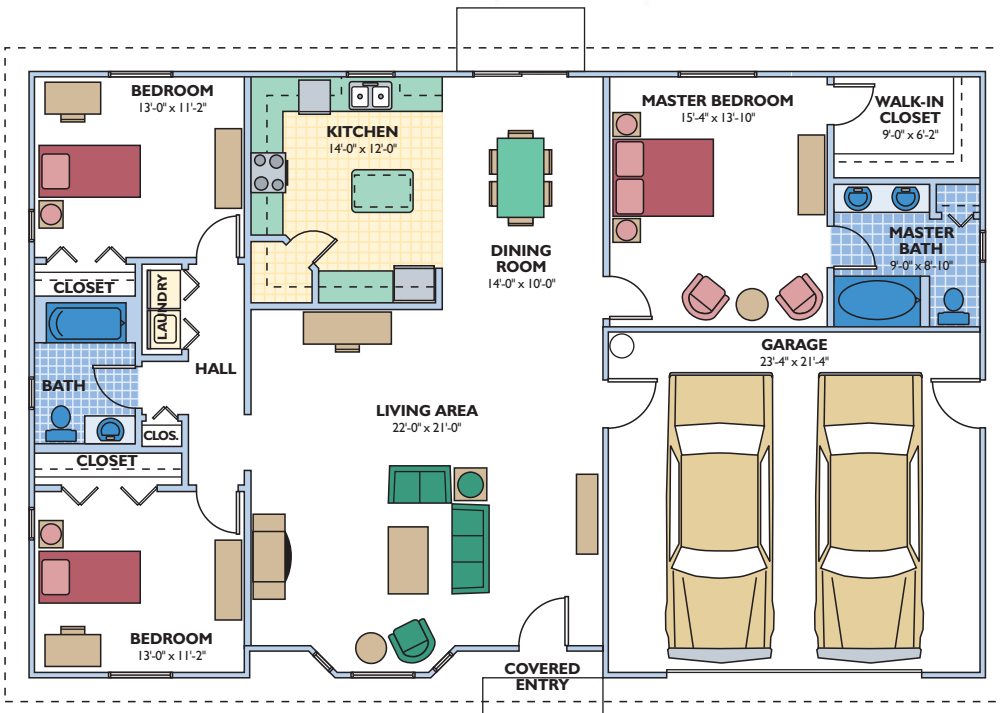
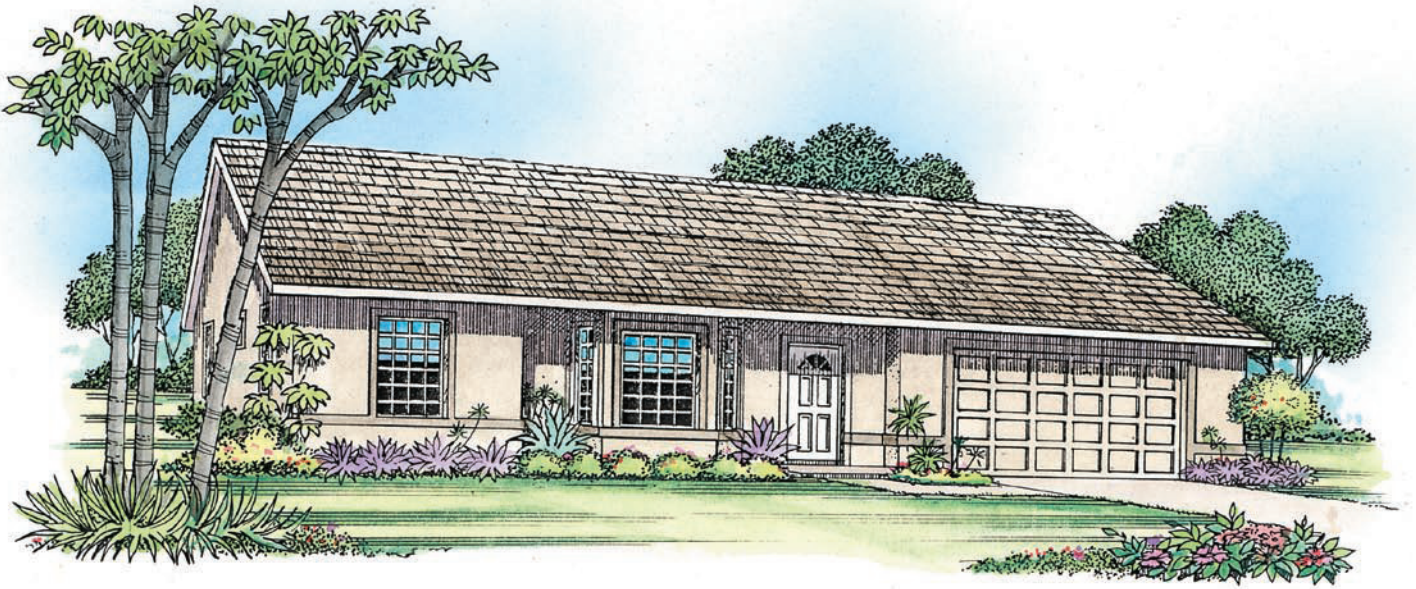

Eco-\$mart offers a complete line of pre-cut and pre-engineered home and building packages utilizing structural insulated panel technology (SIPs).

All packages erect quickly, are stronger than conventional framing and extremely energy efficient. SIPs can be clad in conventional OSB or in steel incorporating the patented Secure-Lock panel connection.

Secure-Lock™ Insulated Panel

Your Choice of Aluminum or Steel Skins

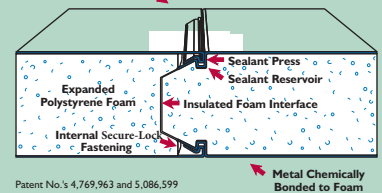

Patent No.'s 4,769,963 and 5,086,599

Dual Plywood Spline Joint

7/16" Nail Base Oriented Strand Board

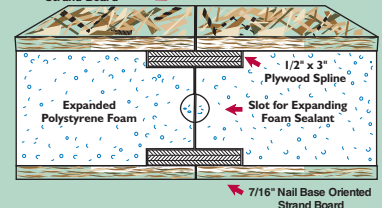

This home has a lot to celebrate. The living room provides plenty of area to relax, and the kitchen has a pantry, lots of counter space and a food preparation island. All the other rooms are of ample size.

Living Area 1,743 sq.ft.
front cov. entry 32 sq.ft.
garage 513 sq.ft.
TOTAL 2,288 sq.ft.

3 bedroom, 2 bath,
2 car garage

Plans and specifications are subject to change without notice. All dimensions are approximate.

ECO-\$MART, INC

TOLL FREE:(888)329-2705 info@eco-smart.com www.eco-smart.com