

ASHLAND

ENERGY WISE HOME

OVERALL DIMENSIONS

41'-8" x 64'-0"



The garage and bedroom extend from the front of this three bedroom home, drawing you visually into the entryway. Brick and stucco are used to further enhance these different depths. Arched openings and columns add an artistic and classical flair. This same attention to detail is seen on the inside of the home. Columns create a sense of elegance, while tray ceilings add definition and character.



Living Area	1825 sq.ft.
Garage	497 sq.ft.
Entry	49 sq.ft.
Porch	186 sq.ft.
TOTAL	2557 sq.ft.
3 bedroom, 2 bath	
2 car garage	

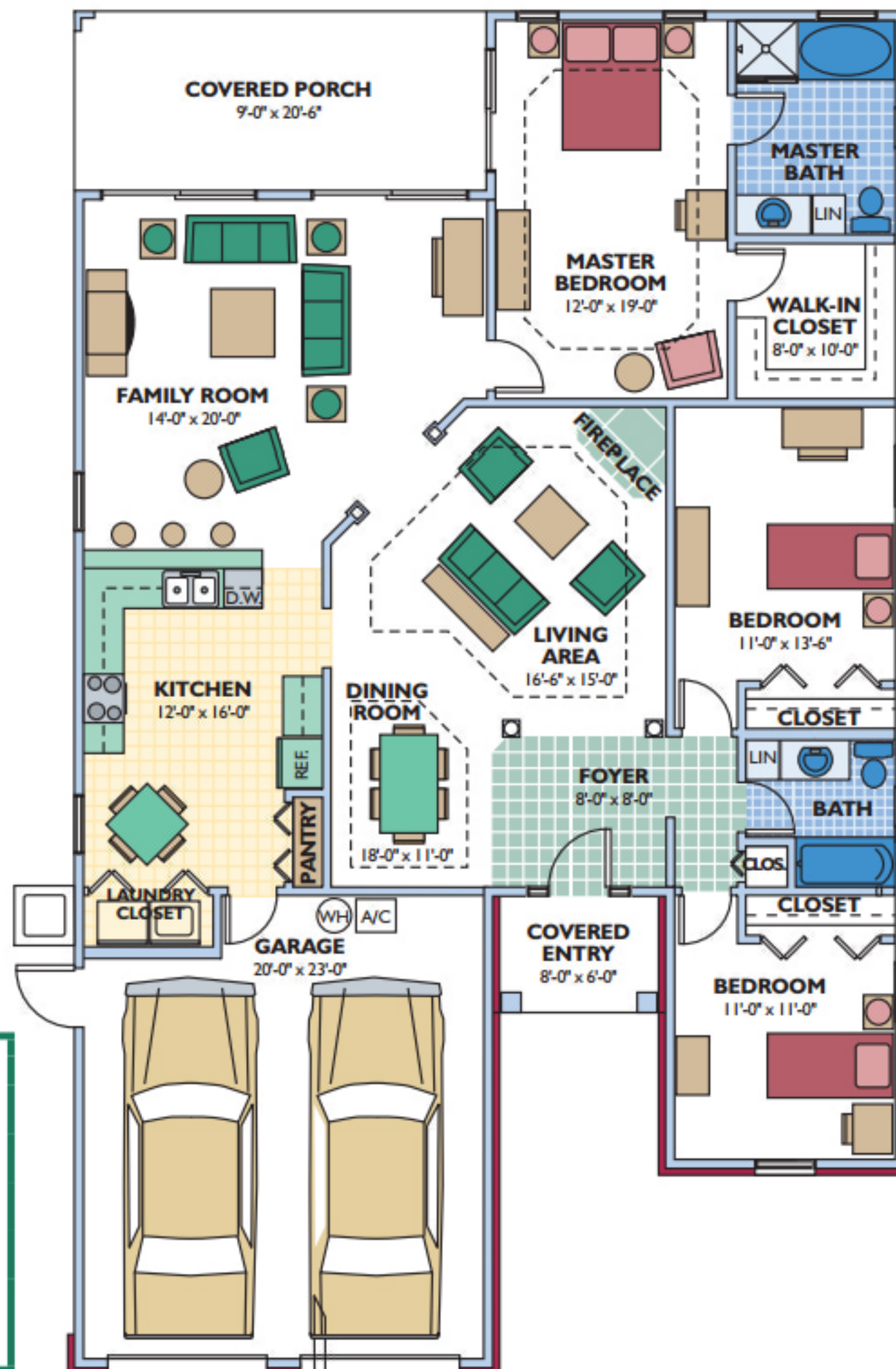

Eco-\$mart offers a complete line of pre-cut and pre-engineered home and building packages utilizing structural insulated panel technology (SIPs). All packages erect quickly, are stronger than conventional framing and extremely energy efficient. SIPs can be clad in conventional OSB or in steel incorporating the patented Secure-Lock panel connection.

Secure-Lock™ Insulated Panel

Your Choice of Aluminum or Steel Skins

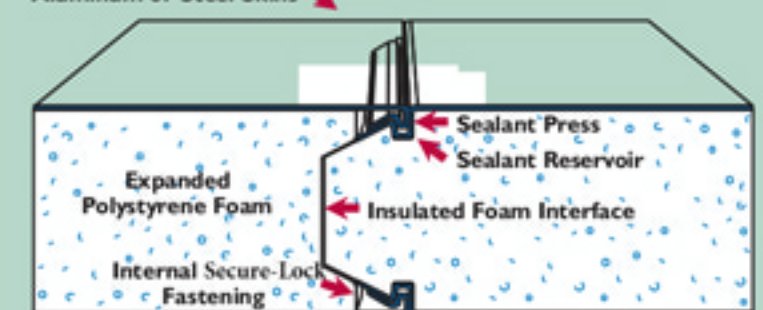

Patent No.'s 4,769,963 and 5,086,599

Metal Chemically Bonded to Foam

Dual Plywood Spline Joint

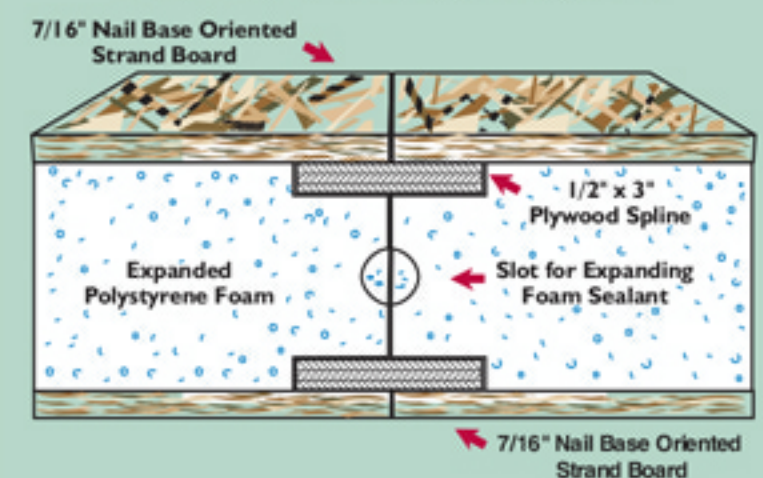

Plans and specifications are subject to change without notice. All dimensions are approximate.

ECO-\$MART, INC

TOLL FREE: (888) 329-2705 info@eco-smart.com www.eco-smart.com

Activate Windows