

UL TypeB LED Tube (DLC4.0 Standard)



Product Description

- ◆ UL Classified,internal Driver(UL typeB) ;
- ◆ Voltage:AC100-277V;
- ◆ High power factor ≥ 0.90 ;
- ◆ Light source: SMD2835;
- ◆ High efficiency, up to 125lm/W;
- ◆ High CRI> 80;
- ◆ Warranty: 5 years.

Dimension

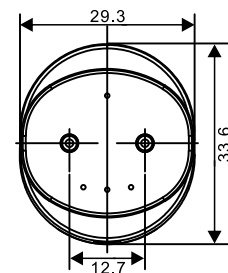
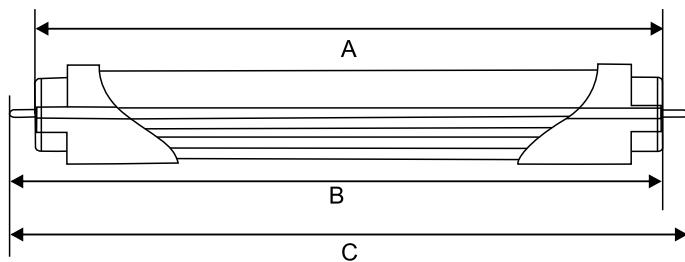

Size(FT)	4			Explain
Length(mm)	Typical	Min	Max	
A	1198	—	1199.4	Base face to base face
B	1205.5	1204.0	1206.5	Base face to end opposite base pin
C	1213	1210.8	1213.6	End of base pin to end of opposlte pin end

Parameters

Size	1.2m/4FT									
Power	18W									
Cover	Milky					Clear				
Color temperature	3000K	3500K	4000K	4500K	5000K	3000K	3500K	4000K	4500K	5000K
Luminous efficacy(LM/W)	115±5%	115±5%	120±5%	120±5%	120±5%	120±5%	120±5%	125±5%	125±5%	125±5%
Lumen output(LM)	2070±5%	2070±5%	2160±5%	2160±5%	2160±5%	2160±5%	2160±5%	2250±5%	2250±5%	2250±5%
CRI	Ra≥80									
Input Voltage	AC 100-277V									
Frequency range	50/60Hz									
Total Harmonic Distortion	<25%									
Beam Angle	120°									
Working Temperature	-20℃~+45℃									
Storage Temperature	-25℃~+65℃									

Size	1.2m/4FT									
Power	22W									
Cover	Milky					Clear				
Color temperature	3000K	3500K	4000K	4500K	5000K	3000K	3500K	4000K	4500K	5000K
Luminous efficacy(LM/W)	115±5%	115±5%	120±5%	120±5%	120±5%	120±5%	120±5%	125±5%	125±5%	125±5%
Lumen output(LM)	2530±5%	2530±5%	2640±5%	2640±5%	2640±5%	2640±5%	2640±5%	2750±5%	2750±5%	2750±5%
CRI	Ra≥80									
Input Voltage	AC 100-277V									
Frequency range	50/60Hz									
Total Harmonic Distortion	<25%									
Beam Angle	120°									
Working Temperature	-20℃~+45℃									
Storage Temperature	-25℃~+65℃									

Optical Data & Diagram

18WB

Illuminance at a Distance			
	Center Beam fc	Beam Width	
17.0ft	4.70 fc	41.6 ft	48.8 ft
34.0ft	1.18 fc	83.2 ft	97.7 ft
51.0ft	0.52 fc	124.8 ft	146.5 ft
68.0ft	0.29 fc	166.5 ft	195.4 ft
85.0ft	0.19 fc	208.1 ft	244.2 ft
102.0ft	0.13 fc	249.7 ft	293.1 ft

■ Vert. Spread: 101.5°
■ Horiz. Spread: 110.3°

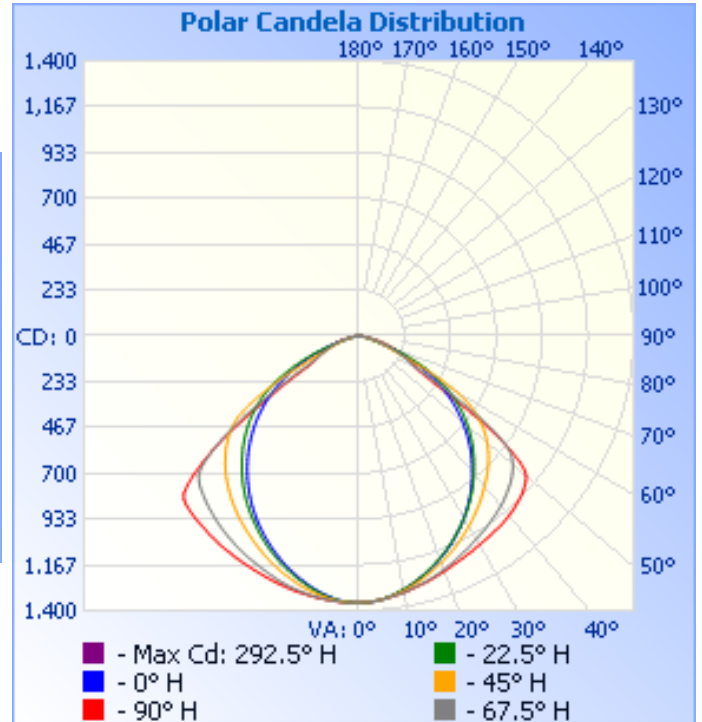

22WB

Illuminance at a Distance			
	Center Beam fc	Beam Width	
17.0ft	6.02 fc	41.4 ft	51.2 ft
34.0ft	1.50 fc	82.8 ft	102.4 ft
51.0ft	0.67 fc	124.2 ft	153.5 ft
68.0ft	0.38 fc	165.6 ft	204.7 ft
85.0ft	0.24 fc	207.1 ft	255.9 ft
102.0ft	0.17 fc	248.5 ft	307.1 ft

■ Vert. Spread: 101.2°
■ Horiz. Spread: 112.8°

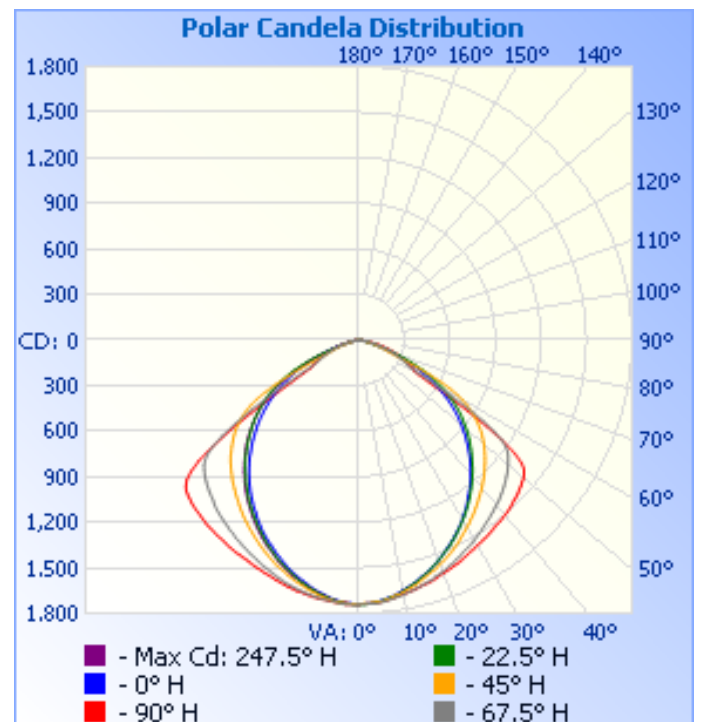

Installation steps

Direct line voltage(AC INPUT)

1. Turn off the electricity supply before installation.
2. Make sure the circuit is as following. Please follow the illustrated steps to revise the circuit as follow

single-ended

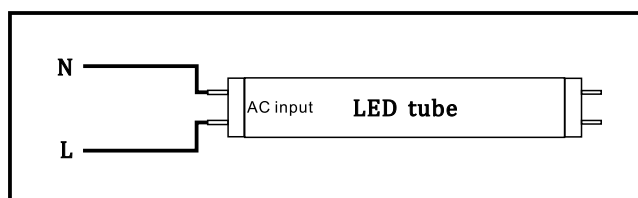

3. install the LED tubes in standard medium bi-pin lamp holder.
4. "After modification completes, then affix the Lamping Replacement Marking label and cautionary label, located this where visible during re-lamping on the retrofitted luminaire."

Package

Item	Carton Size(cm)	Qty	N.W.	G.W.	20GP	40HQ
T8-4FT	124X21X21.5cm	25pcs/carton	0.30kg/pc	10kg/CTN	14000pcs/560CTN	28900pcs/1156CTN

