



# LED 4" & 6" RECESSED ADJUSTABLE DOWNLIGHT



## PRODUCT DESCRIPTION:

Constructed with a high-efficiency LED array and dimmable driver, the Downlight Retrofit features an optical diffuser that produces high lumen transmission and even illumination. The fixtures are suitable for locations. This downlight retrofit is the economical solution for consumers looking to reduce energy costs. These retrofits are offered in a variety of lumen packages appropriate for commercial and residential applications.

## FEATURES:

- High lumen transmission and diffusing for even illumination
- White paint finish standard
- Dimmable down to 2% (see page 2 for recommended dimmers)
- Virtually no UV emitted
- CRI: > 90
- PF: >0.9
- Suitable for use in wet locations  
The working voltage is 100v to 277v
- Five years warranty
- Driver features power factor of > , THD of <20 percent and has integral thermal protection to sense high temperature or internal failure

## CONSTRUCTION:

- One-piece durable die-cast aluminum heat sink with integrated trim
- Module construction includes LEDs, heat sink, lens and baffle trim
- Impact-resistant plastic lens
- Uses spring clips to easily secure into a housing and 4"J-Box

## Luminaire Information:

Model Number	Watts	Inc. Equivalent	Lumens	CRI	Input Voltage	Options	Lamp Life (Hrs.)	CCT	Dimensions Dia" x H"	Carton pcs/box
ECO-A4A-11W	11W	65W	825LM	90	120V		50,000	3000K 4000K 5000K	5.71"x 5.71"x3.75"	24PCS
ECO-A6A-14W	14W	75W	1050LM	90	120V		50,000	3000K 4000K 5000K	7.68" x7.68 "2.4"	15PCS



**Dimension size:**

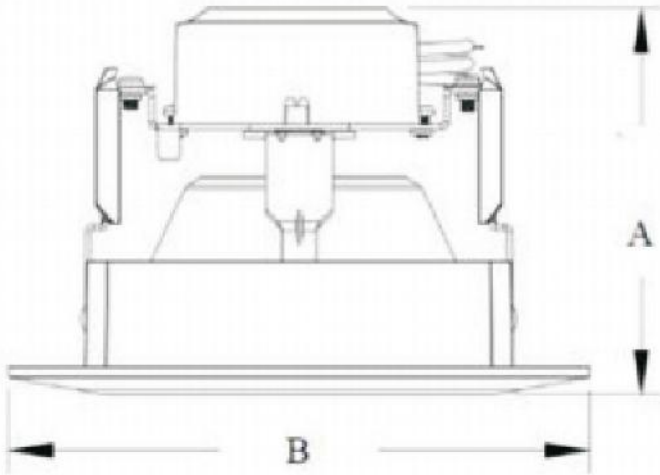

**Luminous Intensity**

Luminous Intensity Distribution Curve

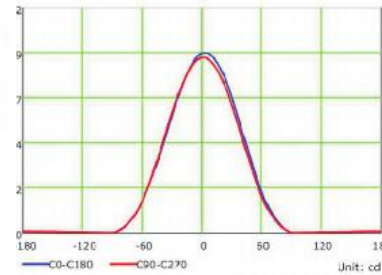
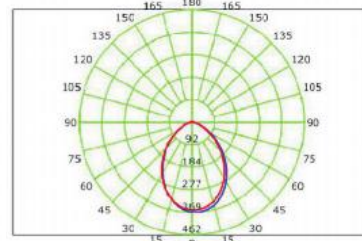

Luminous Intensity Distribution Curve

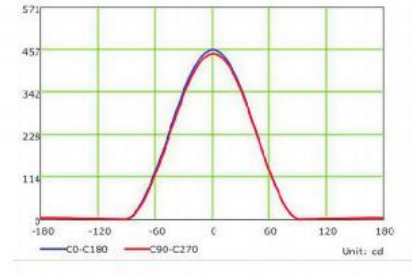
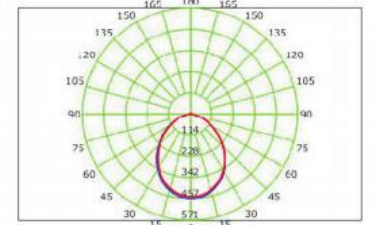

**Dimension Size : (Unit:mm)**

Model	A	B	Size
WHD-A4A-11W	92	130	4"
WHD-A6A-14W	95	182	6"

**Installation Diagram :**

1) 4"

2) 6"

Easy installation (Photos reflect junction)

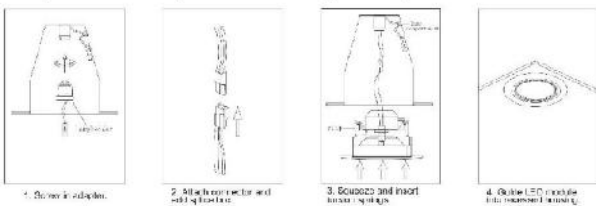

Easy installation (Photos reflect junction)

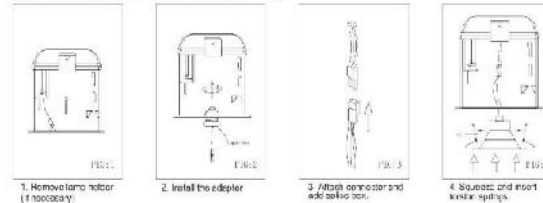

**Suitable occasion :**

